

SMALL SIGNAL AMPLIFIER MODEL ; R&K-AA1020-RS

SPECIFICATIONS

Frequency Range	; 9kHz ~ 8000MHz
Small Signal Gain	; +34dB (typ.) @2GHz ; +31dB (min.)
Gain Flatness	; ±3dB (max.)
Output Power@1dB Comp.	; +11dBm (min.) @2GHz
Output I.C.P.	; +24dBm (typ.) @2GHz
Noise Figure	; 10dB (max.)
NOTE: N.F.value is only guaranteed in the range of 10MHz~8000MHz.	
Impedance	; 50 Ω
Input Return Loss	; 10dB (typ.)
Output Return Loss	; 10dB (typ.)
AC Supply Input	; AC90~240V / 50~60Hz ; 10VA (max.)
Maximum RF Input Power	; -10dBm
Operating Temperature	; -15°C to +45°C
Storage Temperature	; -15°C to +65°C
Connectors (In/Out)	; SMA-FEMALE
Weight	; 3.0kg (max.)

OUTLINE DRAWING

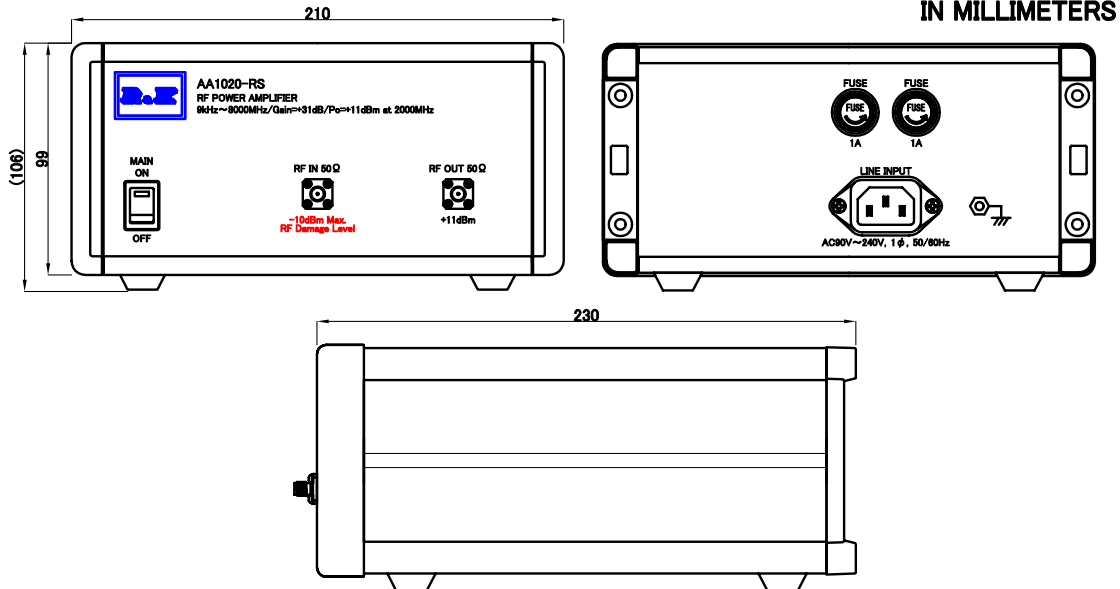

NOTE ; Specifications subject to change without notice.

Revision History			
No	Date	Details	Approved
00	2019/1/23	Original Issue	Tomotaka
01	2020/2/3	Outline Drawing Changes	Yoshikazu

		株式会社 アールアンドケー	
		作成年月日 DRAWN	
三角 縮尺 SCALE 単位 UNIT mm inch	2019/1/23		設計 DESIGNED 作成 DRAWN
	Masahiko Suzuki	Masahiko Suzuki	

AA1020-RS

SPECIFICATION

EK-20-1327-X-01