

SMALL SIGNAL AMPLIFIER

MODEL : R&K-AA200-RS

SPECIFICATIONS

Frequency Range	: 50 - 3000MHz
Small Signal Gain	: +27dB (typ.) @2GHz : +25dB (min.)
Gain Flatness	: ±2.0dB (max.)
Output Power@1dB Comp.	: +35dBm (min.) @2GHz
Output I.C.P.	: +44dBm (typ.) @2GHz
Noise Figure	: 8.5dB (max.)
Impedance	: 50 Ω
Input Return Loss	: -10dB(typ.)
Output Return Loss	: -6dB(typ.)
AC Supply Input	: AC90~240V / 50~60Hz : 50VA (max.)
Maximum RF Input Power	: +13dBm
Operating Temperature	: -15°C to +45°C
Storage Temperature	: -15°C to +65°C
Connectors (In/Out)	: SMA-FEMALE
Weight	: 3.5kg (max.)

OUTLINE DRAWING

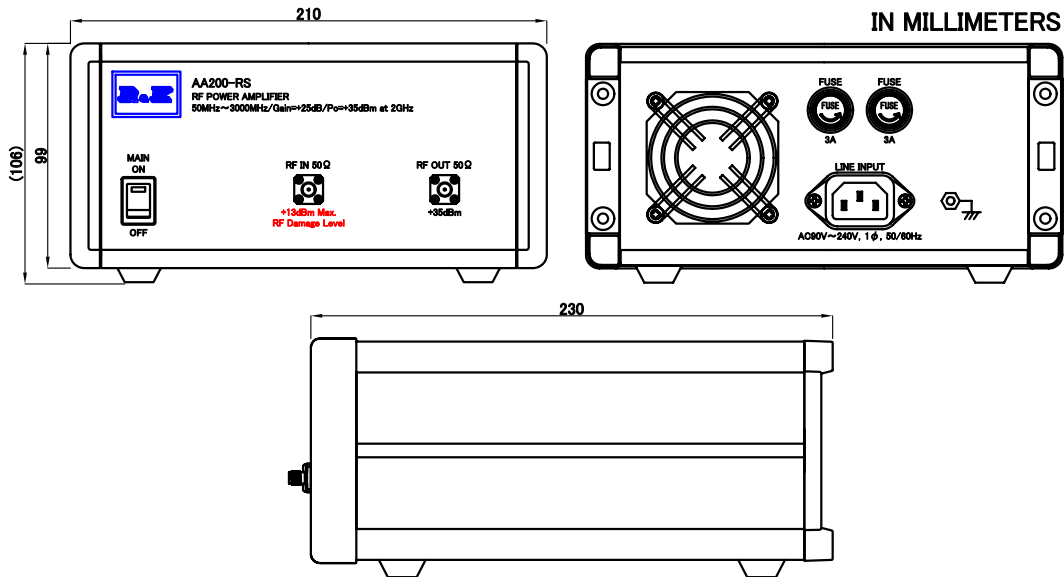

NOTE : Specifications subject to change without notice.

Revision History

No	Date	Details	Approved
00	2018/10/16	Spec. Change	Tomotaka
01	2019/06/25	Outline Drawing Changes	Yoshikazu
02	2021/03/11	Outline & Spec Changes	Yoshikazu
03	2021/11/09	Outline Changes	Yoshikazu



株式会社
アールアンドケー

AA200-RS

縮尺 SCALE	単位 UNIT
mm	inch

作成年月日
DRAWN

2009/11/5

SPECIFICATION

検認
APPROVED

照査
CHECKED

設計
DESIGNED

作成
DRAWN

Masahiko
Suzuki

Tomotaka

Masahiko
Suzuki

Takano

EK-20-0220-3-03