

MODEL ; R&K-AA290-RS

SPECIFICATIONS

Frequency Range	; 0.2 – 300MHz
Small Signal Gain	; +18dB (typ.) @100MHz ; +17dB (min.)
Gain Flatness	; ±1.0dB (max.)
Output Power@1dB Comp.	; +35dBm (min.) @100MHz
Output I.C.P.	; +46dBm (typ.) @100MHz
Noise Figure	; 8.0dB (max.)
Impedance	; 50 Ω
Input VSWR	; 1.5 : 1 (typ.)
Output VSWR	; 3.0 : 1 (typ.)
AC Supply Input	; AC100V 50/60Hz ; 0.4A (max.)
Maximum RF Input Power	; +23dBm
Operating Temperature	; -15°C to +45°C
Storage Temperature	; -15°C to +65°C
Connectors (In/Out)	; SMA-FEMALE
Weight	; 3.0kg (max.)

OUTLINE DRAWING

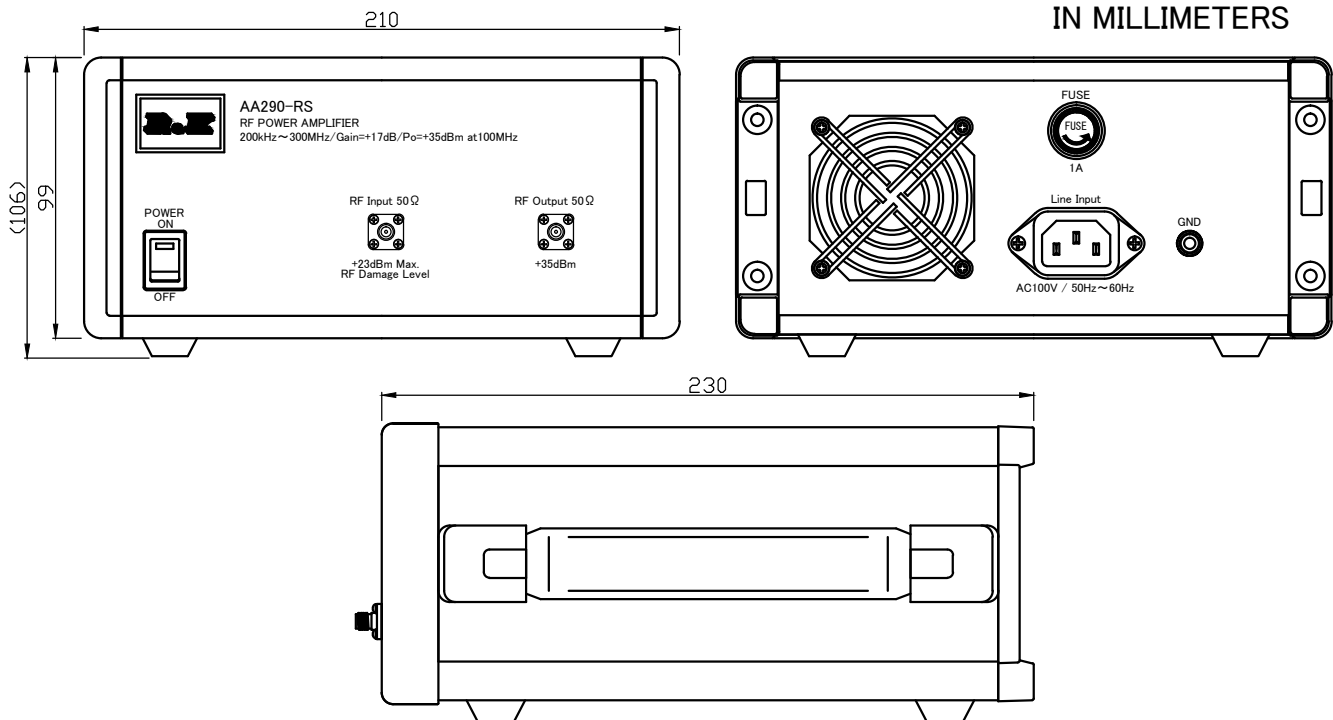

NOTE ; Specifications subject to change without notice.

2018/10/16 Spec. Change



株式会社
アルアンドケー

AA290-RS

三 角 法	縮尺 SCALE	単位 UNIT
	/	mm inch

作成年月日
DRAWN

2009/11/5

仕様書

検認
APPROVED

照査
CHECKED

設計
DESIGNED

作成
DRAWN

Masahiko
Suzuki

Tomotaka

Masahiko
Suzuki

Takano

EK-20-0229-3-00