

SMALL SIGNAL AMPLIFIER

MODEL : R&K-AA410-RS

SPECIFICATIONS

Frequency Range	: 500 – 4000MHz
Small Signal Gain	: +41dB (typ.) @3GHz : +39dB (min.)
Gain Flatness	: ±2.0dB (max.)
Output Power@1dB Comp.	: +32dBm (min.) @3GHz
Output I.C.P.	: +43dBm (typ.) @3GHz
Noise Figure	: 10.0dB (max.)
Impedance	: 50 Ω
Input VSWR	: 1.8 : 1 (typ.)
Output VSWR	: 3.0 : 1 (typ.)
AC Supply Input	: AC90~240V / 50~60Hz : 50VA (max.)
Maximum RF Input Power	: -2dBm
Operating Temperature	: -15°C to +45°C
Storage Temperature	: -15°C to +65°C
Connectors (In/Out)	: SMA-FEMALE
Weight	: 4.5kg (max.)

OUTLINE DRAWING

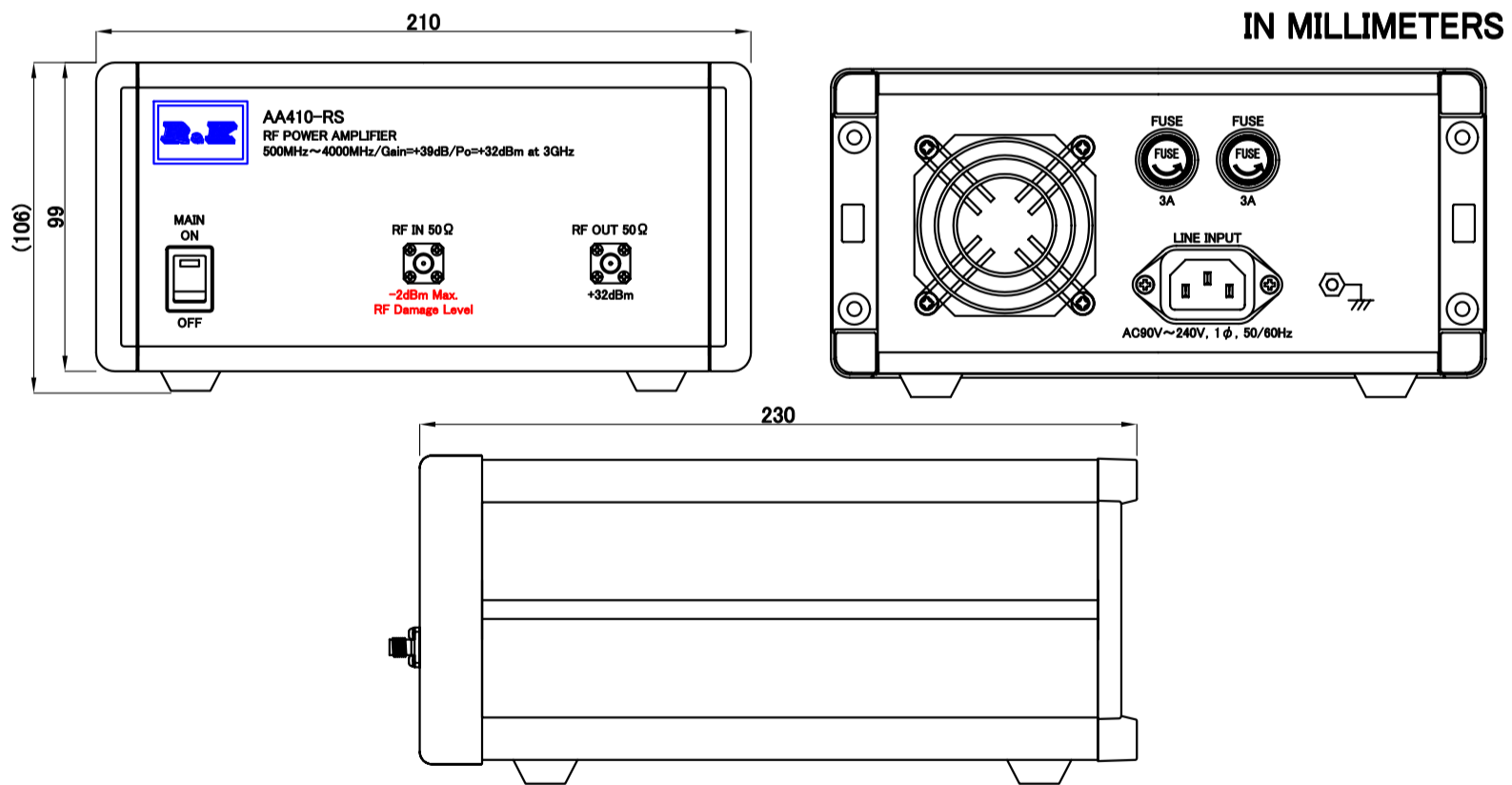

NOTE : Specifications subject to change without notice.

Revision History			
Date	Details	Approved	
00	2015/5/15	Original Issue	Tomotaka
01	2018/10/16	Spec. Changes	Yoshikazu
02	2020/8/28	Outline Drawing Changes	Yoshikazu
03	2022/2/19	Outline Drawing Changes	Yoshikazu

R.K		株式会社 アールアンドケー	
三角法	縮尺 SCALE	単位 UNIT	作成年月日 DRAWN
	mm	inch	2015/5/15
検認 APPROVED	照査 CHECKED	設計 DESIGNED	作成 DRAWN
Masahiko Suzuki	Masahiko Suzuki	Tomotaka	Tomotaka

AA410-RS

SPECIFICATION

EK-20-0241-3-03