

MODEL ; R&K-AA160-RS

SPECIFICATIONS

Frequency Range	; 2 - 3000MHz
Small Signal Gain	; +27dB (typ.) @2GHz ; +25dB (min.)
Gain Flatness	; ±1.5dB (max.)
Output Power@1dB Comp.	; +25dBm (min.) @2GHz
Output I.C.P.	; +37dBm (typ.) @2GHz
Noise Figure	; 8.5dB (max.)
Impedance	; 50 Ω
Input VSWR	; 1.7 : 1 (typ.)
Output VSWR	; 2.0 : 1 (typ.)
AC Supply Input	; AC100V 50/60Hz ; 0.3A (max.)
Maximum RF Input Power	; +5dBm
Operating Temperature	; -15°C to +45°C
Storage Temperature	; -15°C to +65°C
Connectors (In/Out)	; SMA-FEMALE
Weight	; 3.0kg (max.)

OUTLINE DRAWING

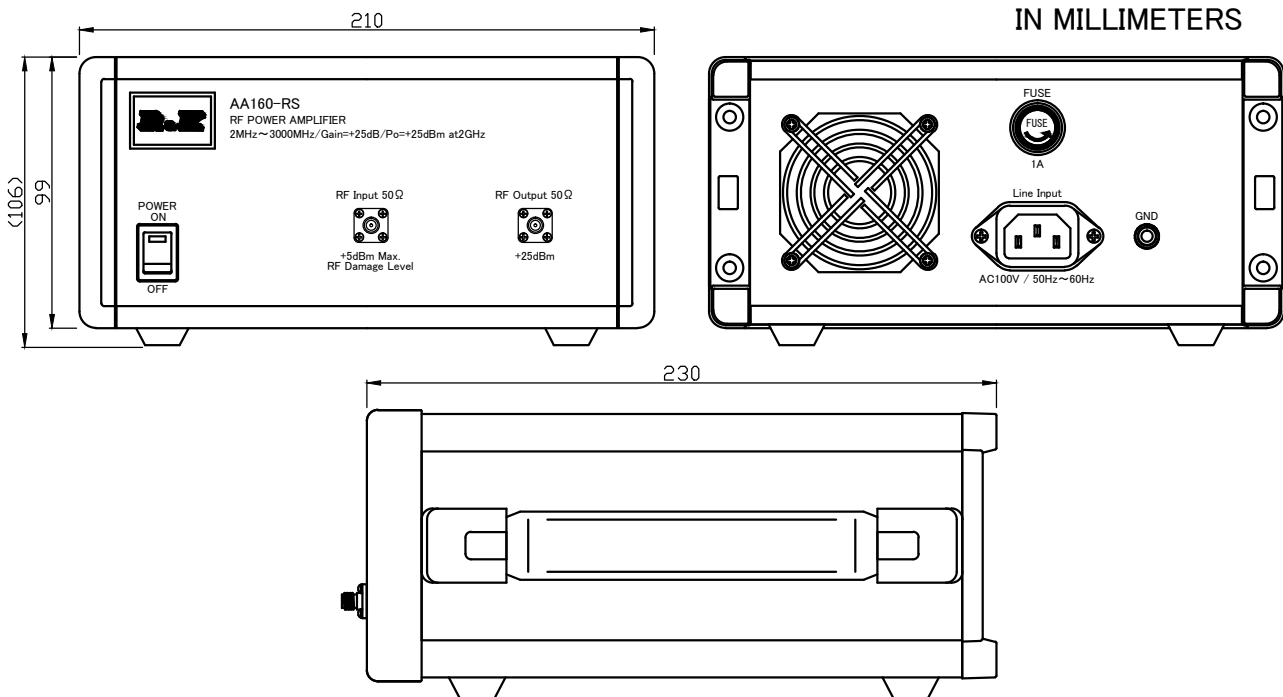

NOTE ; Specifications subject to change without notice.

2018/10/16 Spec. Change

		株式会社	
		アールアンドケー	
縮尺	単位	作成年月日	
SCALE	UNIT	DRAWN	
三角法		2009/11/5	
		inch	
検認	照査	設計	作成
APPROVED	CHECKED	DESIGNED	DRAWN
Masahiko Suzuki	Tomotaka	Masahiko Suzuki	Takano

AA160-RS

仕様書

EK-20-0216-3-00