

SMALL SIGNAL AMPLIFIER

MODEL : R&K-AA1080-RS

SPECIFICATIONS

Frequency Range	: 1MHz - 3000MHz
Small Signal Gain	: +18dB (typ.) @2GHz : 16dB (min.)
Gain Flatness	: ±1.5dB (max.)
Output Power@1dB Comp.	: +29dBm (min.) @2GHz
Output I.C.P.	: +41dBm (typ.) @2GHz
Noise Figure	: 9.0dB (max.)
NOTE: N.F.value is only guaranteed in the range of 10MHz~3000MHz.	
Impedance	: 50 Ω
Input Return Loss	: -10dB(typ.)
Output Return Loss	: -8dB(typ.)
AC Supply Input	: AC90~240V / 50~60Hz : 20VA (max.)
Maximum RF Input Power	: +20dBm
Operating Temperature	: -15°C to +45°C
Storage Temperature	: -15°C to +65°C
Connectors (In/Out)	: SMA-FEMALE
Weight	: 3.5kg (max.)

OUTLINE DRAWING

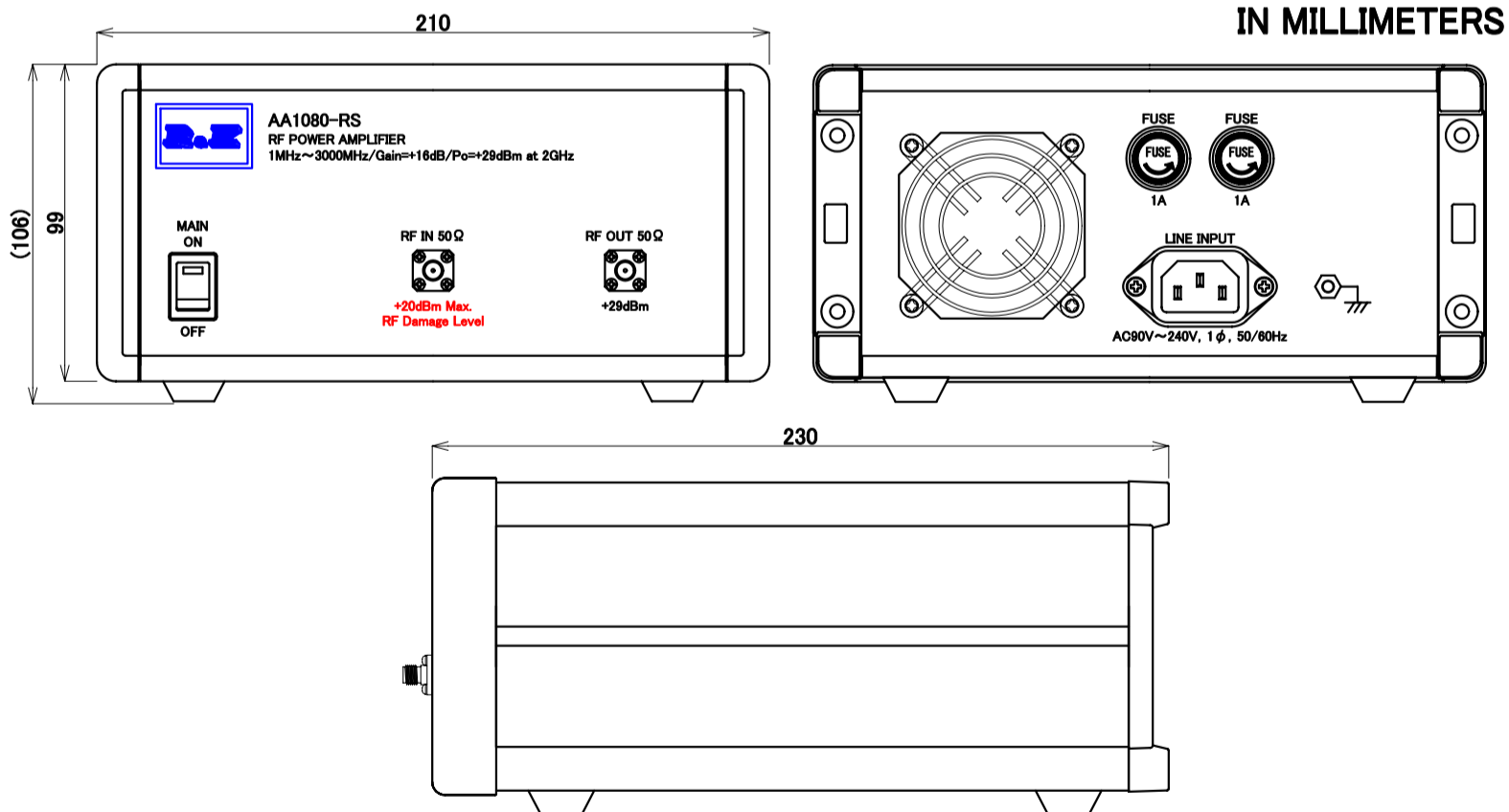

NOTE ; Specifications subject to change without notice.

R.K		株式会社 アールアンドケー	
縮尺 SCALE	単位 UNIT	作成年月日 DRAWN	
三角法	mm inch	2021/06/15	
検認 APPROVED	照査 CHECKED	設計 DESIGNED	作成 DRAWN
Masahiko Suzuki	Masahiko Suzuki	Yoshikazu Sano	Yoshikazu Sano

AA1080-RS

SPECIFICATION

EK-20-1484-X-00