

LOW NOISE AMPLIFIER

MODEL : R&K-LA1040-RS

SPECIFICATIONS

Frequency Range	: 600 ~ 4200MHz
Small Signal Gain	: +31dB (typ.) @2GHz : +29dB (min.)
Gain Flatness	: ±2.0dB (max.)
Output Power@1dB Comp.	: +19dBm (min.) @2GHz
Output I.C.P.	: +32dBm (typ.) @2GHz
Noise Figure @+25°C	: 1.7dB (typ.)
-15°C to +45°C	: 2.5dB (max.)
Impedance	: 50 Ω
Input Return Loss	: 8dB (typ.)
Output Return Loss	: 10dB (typ.)
AC Supply Input	: AC90~240V / 50~60Hz : 20VA (max.)
Maximum RF Input Power	: 0dBm
Operating Temperature	: -15°C to +45°C
Storage Temperature	: -15°C to +65°C
Connectors (In/Out)	: SMA-FEMALE
Weight	: 3.5kg (max.)

OUTLINE DRAWING

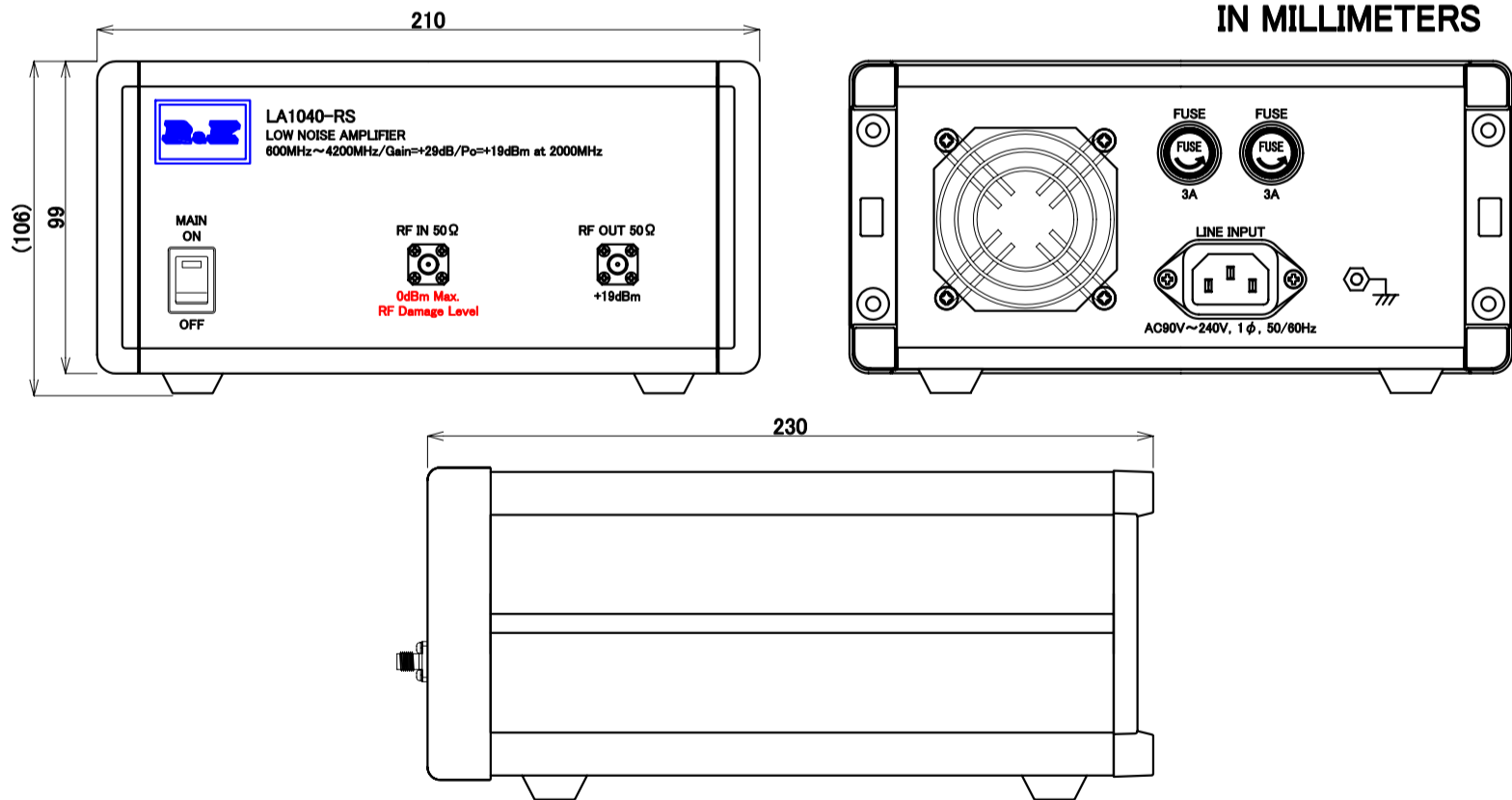

NOTE : Specifications subject to change without notice.

Revision History

No	Date	Details	Approved



株式会社
アールアンドケー

LA1040-RS

縮尺
SCALE
単位
UNIT
mm
inch

作成年月日
DRAWN
2024/8/21

SPECIFICATION

検認
APPROVED
Masahiko
Suzuki

照査
CHECKED
Masahiko
Suzuki

EK-20-1642-X-00

Information disclosed in this document is intended for the sole use of, and distribution by, R&K Company Limited, for purposes of documentation, design, and purchasing. R&K Company Limited reserves all design and proprietary rights to this document, and it may not be used for purposes other than those approved by R&K Company Limited.