

SMALL SIGNAL AMPLIFIER MODEL : R&K-AA1130-RS

SPECIFICATIONS

Frequency Range	: 9kHz ~ 3500MHz
Small Signal Gain	: +42dB (typ.) @2GHz : +38dB (min.)
Gain Flatness	: ±2.0dB (max.)
Output Power@1dB Comp.	: +16dBm (min.) @2GHz
Output I.C.P.	: +30dBm (typ.) @2GHz
Noise Figure	: 5.5dB (max.)
NOTE: N.F.value is only guaranteed in the range of 10MHz~3500MHz.	
Impedance	: 50 Ω
Input Return Loss	: 18dB (typ.)
Output Return Loss	: 13dB (typ.)
AC Supply Input	: AC90~240V / 50~60Hz : 10VA (max.)
Maximum RF Input Power	: -15dBm
Operating Temperature	: -15°C to +45°C
Storage Temperature	: -15°C to +65°C
Connectors (In/Out)	: SMA-FEMALE
Weight	: 3.0kg (max.)

OUTLINE DRAWING

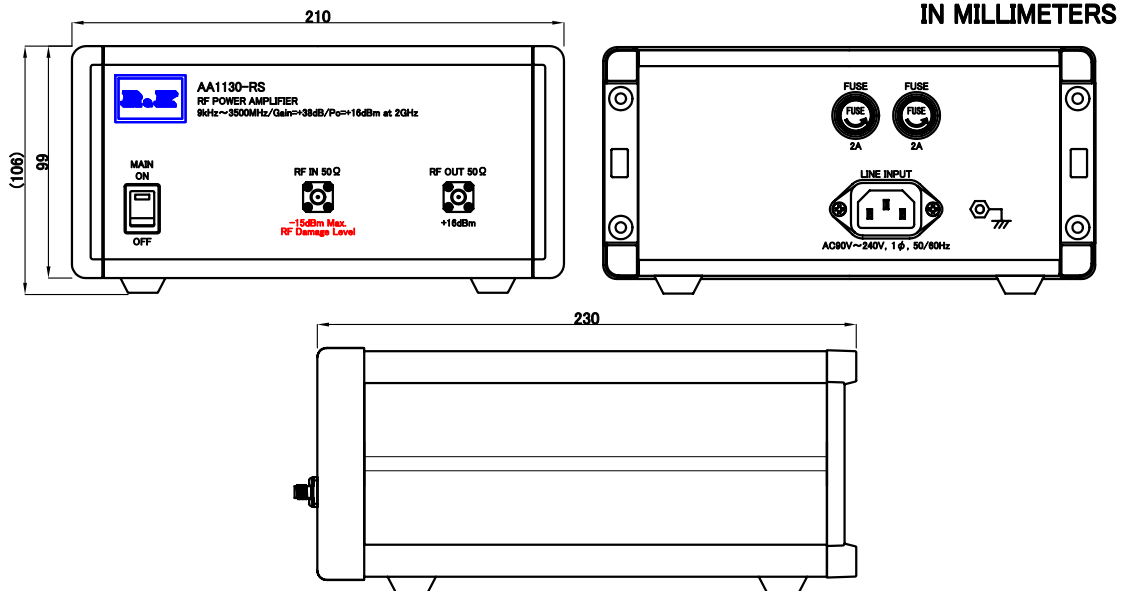

NOTE ; Specifications subject to change without notice.

Revision History

No	Date	Details	Approved
00	2019/8/21	Original Issue	Yoshikazu
01	2020/2/3	Outline Drawing Changes	Yoshikazu
02	2026/2/6	Outline Drawing Changes	Yoshikazu



株式会社
アールアンドケー

AA1130-RS

縮尺
SCALE
単位
UNIT
mm
inch

作成年月日
DRAWN

2019/8/21

SPECIFICATION

検認
APPROVED

照査
CHECKED

設計
DESIGNED

作成
DRAWN

Masahiko
Suzuki

Masahiko
Suzuki

Yoshikazu
Sano

Yoshikazu
Sano

EK-20-1371-X-02